

LIFETIME AFTER FIRE REPLACEMENT GUARANTEE

If your First Alert® Firesafe is ever damaged by a fire, BRK Brands Europe Ltd. will replace it with a comparable model at no charge to the consumer. Freight on the replacement unit is not included in the guarantee and must be paid by the consumer.

For claims, submit your name and address, a photo of the damaged safe along with its Model Number, and a copy of the Fire Department report to BRK Brands Europe Ltd. as proof of loss. Once the information is received, BRK Brands Europe Ltd. will contact you with further instructions.

LIMITED WARRANTY

BRK Brands Europe Ltd., ("The company") warrants that for a period of five (5) years from the date of purchase, this product will be free from defects in material and workmanship. The company, at its sole option, will repair or replace this product or any component of the product found to be defective during the warranty period. Replacement or repair will be made with a new or remanufactured product or component. If the product is no longer available, replacement may be made with a similar product of equal or greater value. This is your exclusive warranty.

This warranty is only valid for the original retail purchaser from the date of initial retail purchase and is not transferable. You must keep the original sales receipt. Proof of purchase is required to obtain warranty performance. BRK Brands Europe dealers, service centres, or retail stores selling this product do not have the right to alter, modify or in any way change the terms and conditions of this warranty.

This warranty does not apply to the finish on the product. This warranty does not cover normal wear and tear of parts or damage resulting from any of the following: negligent use or misuse of the product, use contrary to the operating instructions, disassembly, repair or alteration by anyone other than the company or an authorized service center, improper installation, or exposure to extremes of heat or humidity. Further, the warranty does not cover Acts of God, such as fire, flood, hurricanes and tornadoes.

The company shall not be liable for any incidental or consequential damages caused by the breach of any express or implied warranty. The company is also not responsible for: costs associated with removing or installing the product; damage or loss of the contents of the product; nor for the unauthorized removal of the contents; or damages incurred during shipment.

Except to the extent prohibited by applicable law, any implied warranty of merchantability or fitness for a particular purpose is limited in duration to the duration of the above Warranty Period.

If you have any questions that cannot be answered by reading this manual, contact BRK Brands Europe Ltd.

BRK Brands Europe Ltd
Unit 6, Carter Court
Davy Way
Waterwells Business Park
Quedgeley
Gloucester
GL2 2DE
United Kingdom

Email: info@firstalert.eu
Web: www.firstalert.eu

First Alert®



Model **2096DFE**

Fire / Water Theft Safe

with Emergency Override Key

Read These Instructions Very Carefully!

Overview of Your SafePage **1**

Opening Safe For The First Time.....Page **2**

Test Locking System.....Page **3**

Programming a Personal PasscodePage **5**

**Emergency Override Key/
Battery Replacement**.....Page **6**

Additional Features.....Page **7**

Use, Care and MaintenancePage **8**

Consumer AffairsPage **9**

Handy Hauler® Handle and WheelsPage **11**

Model Number _____

Serial Number _____

Key Number _____

Digital Passcode Record



Your Passcode must be at least 3 digits and no more than 8 digits followed by the # sign.

Important:
Once your personal Passcode is programmed, the factory pre-set code will no longer open the safe.

For Your Protection

- Do not remove the Serial Number tag from the safe.
- Store Emergency Override Keys away from (NEVER INSIDE) safe.
- Record all Safe Identification Numbers on Safe Identification Record (last page).
- Save this manual and NEVER keep it inside the safe.

WELCOME!

Your new First Alert® Fire/ Water/ Theft Safe will provide years of safe and secure protection for your valuables, important documents and other personal items. All First Alert® safes are designed and built using the highest manufacturing standards to ensure maximum user satisfaction under a variety of conditions. With proper care, your First Alert® safe will provide “Peace of Mind” for many years to come.

Thank you and Enjoy!

The following list outlines the items and quantities of each included with your new safe. Please carefully check the list to confirm all items have been received. If any item is missing, then please contact BRK Brands Europe Ltd.

- Operation & Installation Guide 1 ea.
- Emergency Override Key 2 ea.
- Adjustable Shelf 2 ea.
- AA Batteries 4 ea.
- Removable File Rack 1 ea.
- Removable “Handy Hauler®” Handle 1 ea.

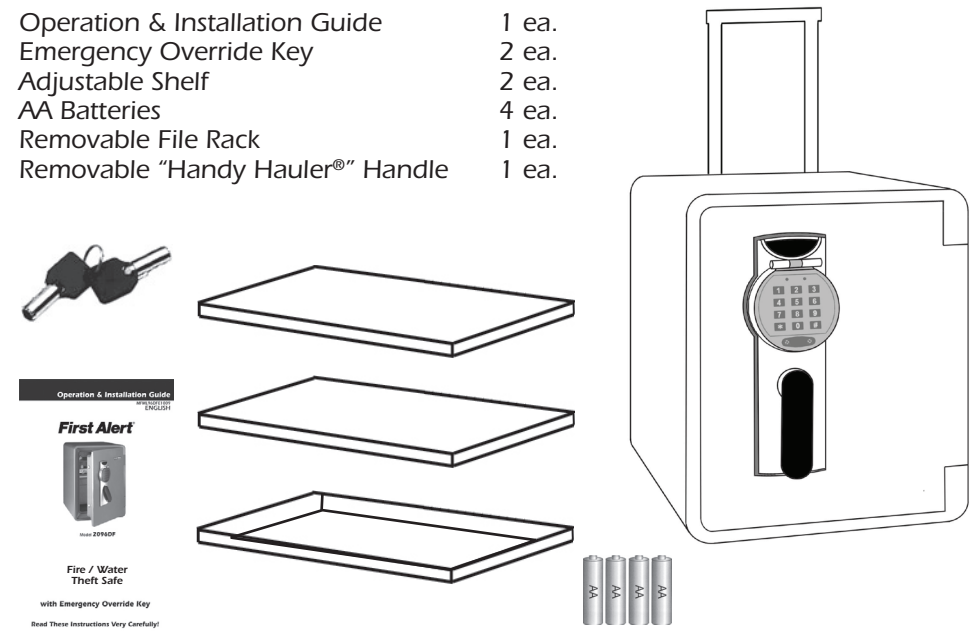

Important: DO NOT RETURN SAFE TO STORE

If you are missing parts, have difficulty programming your safe or have any other questions pertaining to its proper use and care, DO NOT RETURN your safe to the store. Please Contact BRK Brands Europe Ltd. To assist us in serving you, please have the model number and date of purchase available when calling.

Important: FIRST TIME ACTIVATION

Your safe is ready for activation. To allow the safe to be opened and to prevent locking of the safe prior to completing the first-time user activation procedures, a solenoid deactivation safety device has been installed.

Batteries and Emergency Override Keys

Remove 4 "AA" batteries and 2 Emergency Override Keys. They are located in the protective Polystyrene insert at the top of the box.

User Activation

Install Batteries

1. Turn handle upwards to the right and pull open the safe door.
2. Slide the battery compartment cover (located inside the safe at the top of the door) forward and remove. Install the 4 "AA" batteries. Make sure the batteries are installed in the proper direction as indicated in the battery compartment. Slide the cover back into place.
3. After the batteries are correctly installed, the red and green lights located at the top of the keypad on the front of the safe will blink twice, the keypad backlight will flash once and you will hear a single beep.
4. Proceed to Activate Lock.

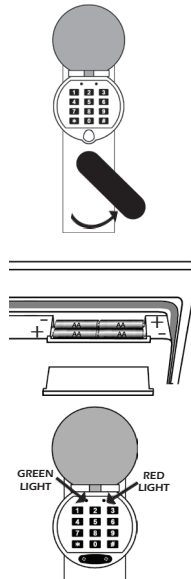

Important: ENABLE/DISABLE SOUND

Once the batteries are installed, if you do not hear a beep when entering the factory pre-set Passcode or during the personal Passcode re-programming process, enter the following key sequence into the digital keypad: # * # This will turn the sound on. Repeat the process if you want the sound turned off.

Activate Lock

1. Locate the small plastic Locking Pin on the inside of the safe door. Grip and pull out completely. Pin can then be properly discarded.
2. Leave the safe door open and proceed to Electronic Locking System Test.

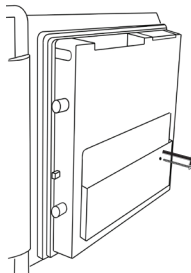

This First Alert® safe is equipped with our exclusive Handy Hauler® removable handle/wheel assembly that allows the safe to be rolled easily into position in your home or office.

The following steps should be followed to initially position the safe or to relocate it at a later date:

1. To extend the handle, pull upwards until the handle clicks and locks into position.
2. If the handle has previously been removed, insert it back into the brackets on the safe and push it down until it snaps into the extended and locked position.
3. Place your foot against the base of the safe and tilt it forward using the handle. This allows the wheels to extend, and the safe can now be rolled to the designated area.
4. Once the safe has been properly positioned, it is recommended that the handle be removed, thereby preventing unauthorized moving. To remove the handle, push in on the small release buttons located on each side of the handle and lift upwards. Once removed, store in a secure location for future use.

How to Obtain Warranty Service

If service is required, do not return the product to your retailer. In order to obtain warranty service, contact:

BRK Brands Europe Ltd
Unit 6, Carter Court
Davy Way
Waterwells Business Park
Quedgeley
Gloucester
GL2 2DE
United Kingdom

Email: info@firstalert.eu
Web: www.firstalert.eu

Ordering Replacement Keys

Additional keys can be purchased from BRK Brands Europe LTD. Please have the following information ready:

- Name / Address / Telephone
- Safe Model Number / Serial Number
- Key Number (located on the key and on the Emergency Override Key lock)
- Number of keys requested

Electronic Locking System Test

With the door still open, you can test the Electronic Digital Lock by manually activating the Locking System.

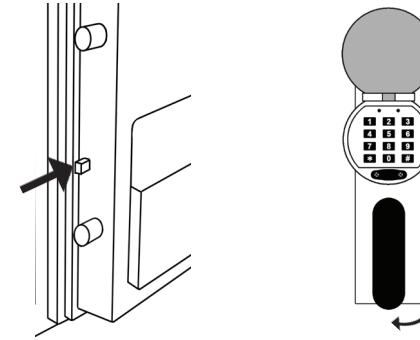

To activate the Locking System, locate the Locking Push Button on the inside of the safe door, push it in and turn the handle downward to the left. This will cause the Live Bolts to extend out and into the "locked" position. Now with the door open and the Live Bolts in the locked position, you may proceed to Testing the Passcode.

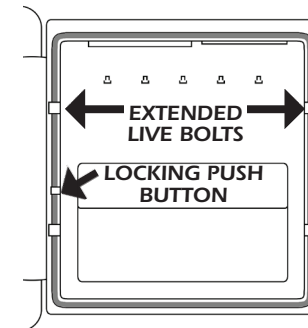

Important: ENGAGING LIVE BOLTS

Closing the safe door with the Live Bolts in the locked (extended) position can damage the safe. The Locking Push Button should only be used when testing or programming the safe with the door remaining open.

Testing the Passcode

1. With the safe door open and the Live Bolts engaged, you can now test the Electronic Locking System using the pre-set three digit factory code. Locate the digital keypad on the front of the safe and open up the protective cover to expose the keypad.
2. When the cover is opened, the keypad is activated and the keypad backlight will turn on and remain on for approximately 5 seconds. When the backlight turns off, the keypad is still active and the backlight will turn on again when any key is pressed.
3. The pre-set three digit factory Passcode is 159. Enter this Passcode as follows:



Note: All entries are accompanied by a beep and the green light will flash.

4. After properly entering the entire sequence, the green light will turn on and the lock will “click”. You now have 5 seconds to open the safe by turning the safe door handle upward to the right.

Important: IF HANDLE WILL NOT TURN

If the handle will not turn to the right after the green light comes on, first turn the handle slightly back to the left until it stops, then turn upwards to the right again to open.

5. Once the handle has been turned to the right, the Live Bolts will disengage and retract into the door. You have successfully unlocked the safe and the door is now in the unlocked position.
6. Leave the safe door open and proceed to Programming a Personal Passcode.

Important: SECURITY LOCKOUT PERIODS

For added security, the safe will automatically lock out entry for 15 minutes after three attempts to open with an invalid Passcode.

Your Safe's Unique Identification Numbers

When contacting BRK Brands Europe Ltd. you should be prepared to supply some important information that specifically identifies your safe. This information is extremely important to assuring prompt and accurate customer assistance.

It is strongly recommended that you identify and record the following information in the “Safe Identification Record” form located on the inside back cover of this manual:

Model Number

Serial Number

Key Number

Locating Model and Serial Numbers

Most First Alert® safes include a small metallic silver or grey tag affixed to one of the surfaces. This tag is usually located on the front or right side of the safe. This tag contains the Serial Number, and on selected models a similar tag is attached containing the Model Number. If a Model Number tag is not attached to the safe, then it can be located on the front or side panel of the box that the safe was packaged in. Write this number down for future reference.

Key Number

The Key Number is located on the key. If you do not have the key, the number is also located on a sticker on the inside of the Emergency Override Key lock cover. (See Emergency Override Key, page 6)

Important: DO NOT REMOVE TAGS!

In case your safe becomes inoperable or you lose your keys, these identification numbers will be needed to correct the problem. It is recommended that the number tags remain in place on the safe. If removal is necessary, then they should be attached to the inside back cover of the Operation and Installation Guide. Store in a safe and secure place for future reference.

Appropriate Use of Your Safe

First Alert® fire safes protect paper records and many other valuables.

Verified fire protection for:

Memory sticks, CDs & DVDs, USB Drives.

This product is NOT INTENDED to protect audio or video cassettes, floppy discs, data cartridges, film and photos or photo negatives.

Testing shows that the interior temperature of the safe remains below 350°F (177°C) for 1 hour during a fire up to 1700°F (927°C) when used properly. Your safe must be closed and latched in order to properly protect the contents from fire.

Waterproof even when fully submerged

Moisture Warning

We recommend that you place delicate items such as pictures or intricate jewelry into an air-tight container **before** storing them in your safe. Avoid placing your safe in areas of high humidity. For optimum performance, the safe should be opened and aired out for at least 20 minutes every two weeks.

Firearms Warning

This safe is **not** designed to store medication, items with combustible content, guns or other weapons.

Pearls

Because pearls sustain heat damage at temperatures below 350° F, we advise that you **DO NOT** store pearls in this fire safe.

Safe Care and Maintenance

When properly maintained, your safe will continue to operate and accurately read the authorized Passcode for many years. In order to ensure optimum performance of your safe, please follow these simple precautions:

Replace Batteries – For best results and performance, we recommend that the batteries be replaced at least once a year or sooner depending on amount of use. Clean the battery contacts in the battery compartment and on the batteries before installing new batteries.

Clean Hands - Never attempt to operate the digital keypad if your hands have excessive dirt, debris or liquids on them.

Clean Safe – To clean the surface of your safe, it is recommended that you use a mild cleaner (e.g., window cleaner) to avoid scratching or discoloring the surface. Always wipe dry and NEVER use abrasive cleansers on the safe or digital keypad.

For future reference, store this Operation and Installation Guide in a secure area away from the safe. **DO NOT DISCARD!**

Programming a Personal Passcode

For security reasons, it is very important that you program your own personal Passcode into the digital lock. The factory code 159 should be changed immediately.

To program your own unique 3-8 digit Passcode, follow these steps:

1. With the safe in the open position, press in on the small reset button located on the inside top edge of the door.

NOTE: After pressing the reset button, the red and green lights on the keypad will flash to indicate the programming is authorized and you have 10 seconds to begin.

2. Open the protective cover on the front of the safe to expose the keypad.
3. Enter your new 3-8 digit Passcode followed by the # Key. Immediately repeat the sequence, beginning with the new Passcode followed by the # Key.

P A S S C O D E #

P A S S C O D E #

4. The green light will light up solid, indicating your new Passcode has been successfully entered.
5. Your new Passcode will now be comprised of the 3-8 digit sequence you selected, always followed by the # sign. The factory pre-set Passcode will no longer open the safe.
6. You may change your Passcode at any time by repeating the same steps.
7. It is important that you write down your personal Passcode and secure it in a safe location away from the safe.

NOTE: If you forget your personal Passcode, access to the safe can be made using the Emergency Override Key. (See page 6)

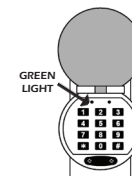
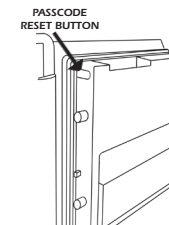

Emergency Override Key/ Battery Replacement

Additional Features

Your safe is equipped with an Emergency Override Key which allows immediate access in case you forget your Passcode or the batteries need replacing.

1. Locate and open the protective keypad cover on the front of the safe.
2. Using a small Phillips head screwdriver, remove the 2 screws securing the small Emergency Override Key lock cover located just below the digital keypad. Pull forward on the cover to remove and set aside with the small screws.
3. Insert the Emergency Override Key into the lock and turn clockwise to the right.
4. Turn the handle upwards to the right to open the safe.

NOTE: If batteries need replacing, proceed with step 5. Otherwise, proceed to steps 6-8.
5. Slide the battery compartment cover (located inside the safe at the top of the door) forward and remove. Remove and properly dispose of the (4) nonworking batteries. Install 4 new "AA" batteries. Make sure the batteries are installed in the proper direction as indicated in the battery compartment. Slide the cover back into place.
6. Remove the Emergency Override Key, and before replacing the lock cover, enter your personal Passcode to make sure the safe will open.
7. Replace the lock cover using the 2 small screws and return the Emergency Override Key to a secure place away from the safe.
8. Close and lock the safe door.

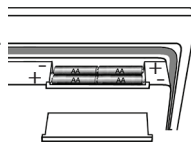
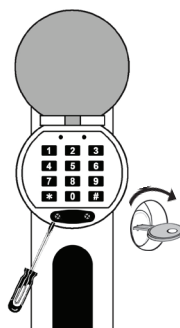

Shelves

To allow for greater flexibility and further accommodate your particular storage needs, this safe includes (1) Adjustable/Removable Shelf.

1. Position shelf so that the gripping ridges are on the top and towards the front of the safe.
2. Locate the approximate position in the safe where you would like to place the shelf and, using the guides molded into the walls of the safe, slide into place.

Removable File Rack

For your convenience, this safe also includes (1) pre-installed Removable File Rack. If you would like to remove or re-position the File Rack, simply grasp it on both sides, pull forward, and lift it up and out of the safe. To re-install the File Rack, locate the approximate position in the safe where you would like to place it and, using the guides molded into the walls of the safe, slide into place.

Low Battery Indicator

Every time the keypad is activated, the system automatically checks the power level remaining in the batteries. If the power falls below a certain level, the red light will flash every two seconds to indicate the need for new batteries. See page 6 for instructions on replacing the batteries.

Disable / Enable Sound

1. To Enable (Turn on) the sound during normal operation, press the following key sequence:



2. Repeat the process to turn the sound off.